



MODZ
SIDESTEP
INSTALL MANUAL

**EVOLUTION
D5**

A central graphic featuring a black and white photograph of a modern architectural structure, possibly a stadium or arena, with a complex, curved, and grid-like facade. The image is oriented vertically and appears to be looking up at the structure.

Hardware:

***Note:** Some hardware can be located in box 1 and some in box 2.
Carriage bolts M8x20mm M8 Flang Nuts Carriage bolts 50mm



10mm hex M6 Bolts



10mm hex M6 Nuts

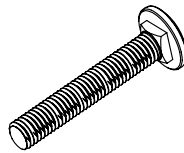

M6 Flat washer

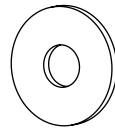
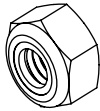
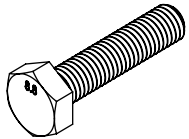

Tools:

- 3/8" Ratchet or Impact Driver
- 8mm Wrench (To customize MODZ plate)
- Torque Wrench (recommended)
- Cutters for Zip Ties
- 13mm & 10mm Long Socket
- Bubble Level
- Jack Stands
- Floor Jack
- Zip Ties

Components:

***Note:** D5 carts (Rover) will require two bracket kits and two side step kits. (long step kit and two short step kit.) D5 (Terra) cart only requires one bracket kit and one long step kit*

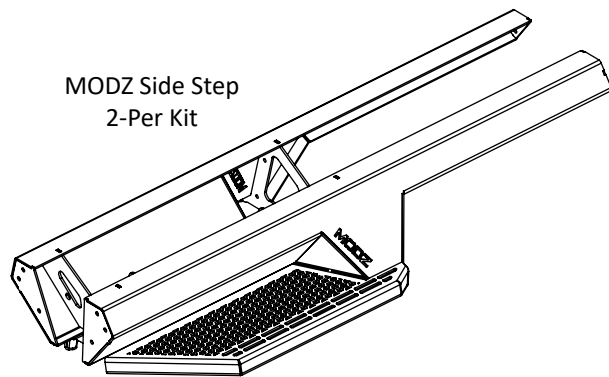

MODZ Side Step
2-Per Kit

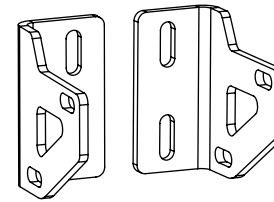

Step Adjustment
Bracket (4-per kit)

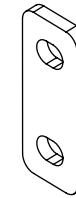

Fastening plate (4-per
kit)

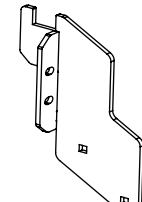

Frame bracket (4-per
kit)

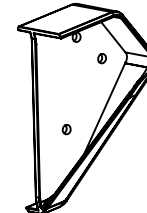

Sidestep Mid Joint
(2X)

Note: This is only needed for D5 rover.

SIDESTEP SUP-ASSEMBLY: *This is only for D5 Rover. Ignore step 1 if you have the D5 Terra cart.*

STEP 1:

- Starting with the driver's side, remove the end cap from the longer sidestep and set it to the side. Next, remove the front plastic cap from the shorter sidestep and set it to the side.
- Position the longer sidestep in front of the shorter sidestep as shown in the image below. Next, use the sidestep mid joint and (3) M6 bolts to connect the two halves.

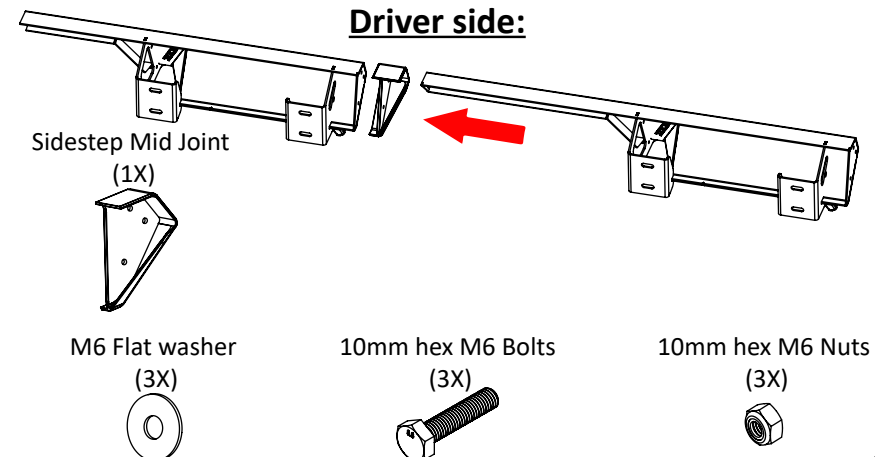

- Confirm you have the correct orientation.

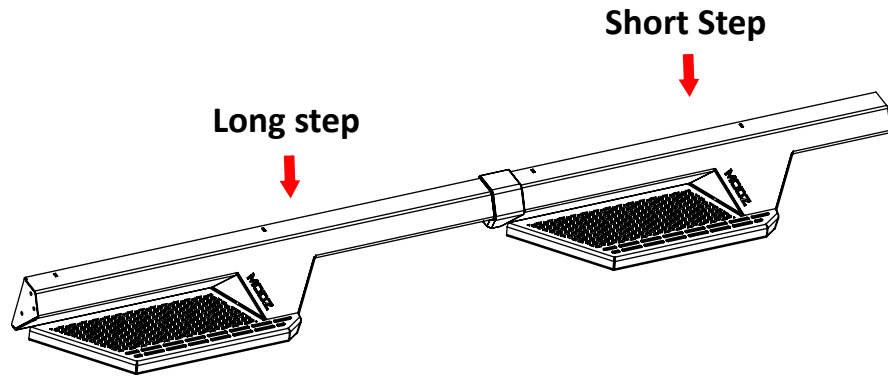

STEP 2:

- Attach the adjustment brackets to the slotted holes on the back side of the sidesteps with (8) M8x20 Bolts and M8 Nuts. Keep hardware loose.

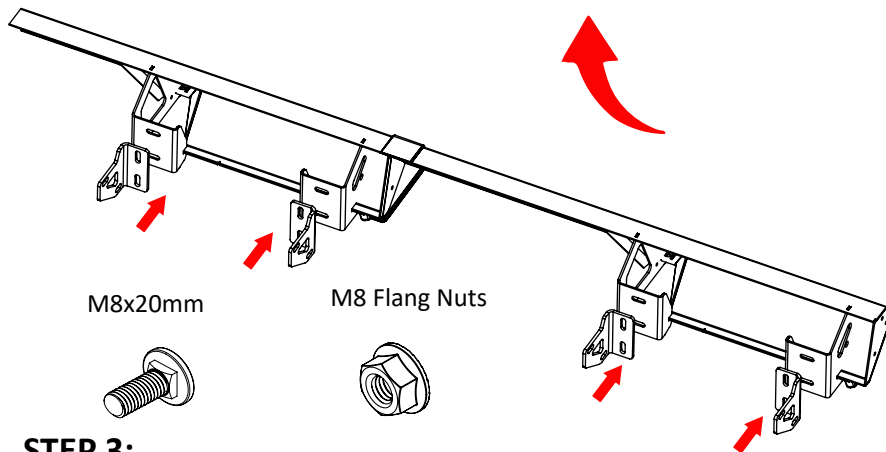

STEP 3:

- Looking under the D5 cart you will see a 1" rail welded to the bottom side of the frame. There is a 2" Gap between the rail and the frame.

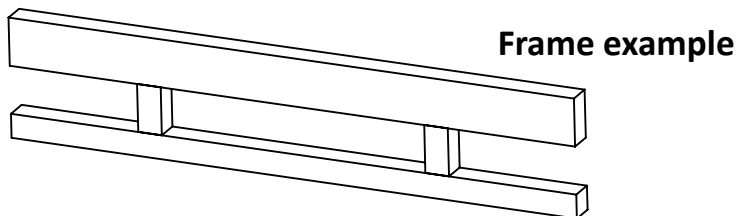

- Starting with the driver's side. Take one Frame bracket, turn the bracket horizontal, parallel to the frame, and place it between the frame and the rail.

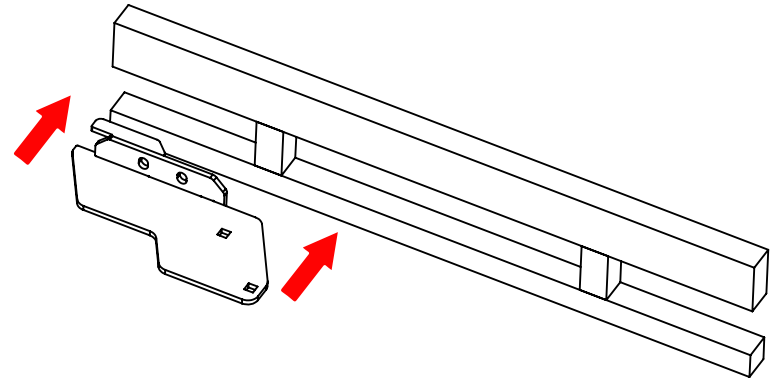

- Rotate the bracket 90 degrees perpendicular to the frame, locking the bracket into place.

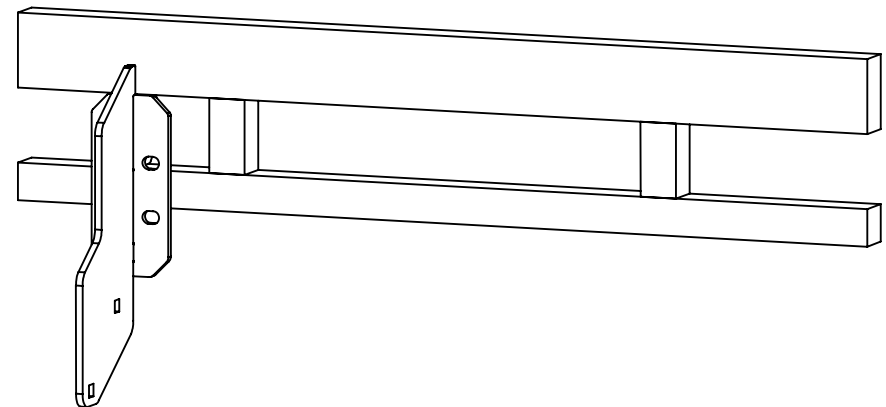
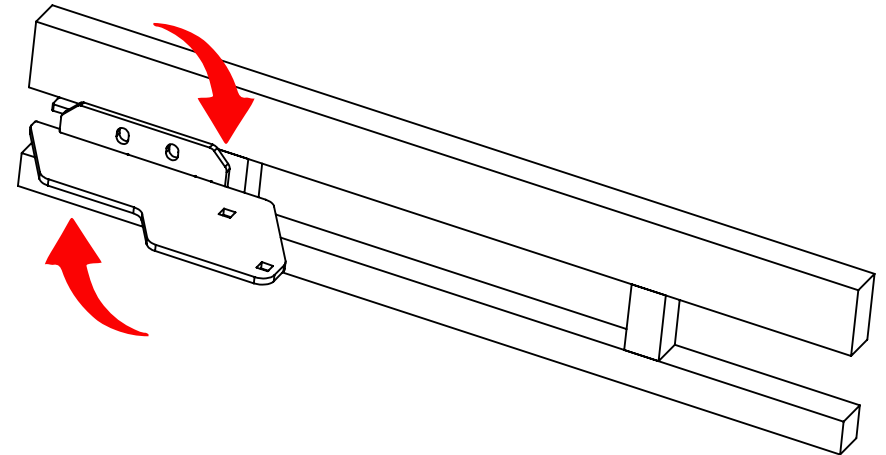

Position your first frame bracket as close to the front tire as possible for both the driver and passenger sides.

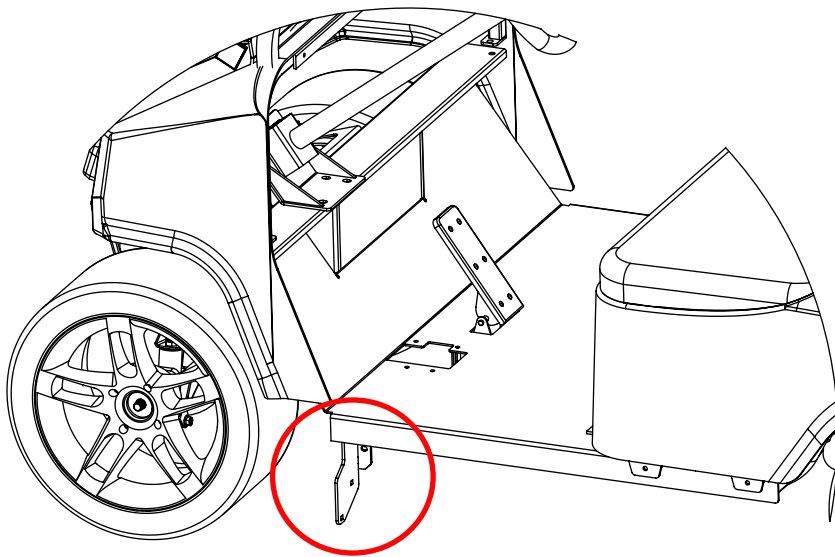

STEP 3:

Install the remaining Frame brackets Remembering to space them out 14in (Inside to inside) from the front bracket.

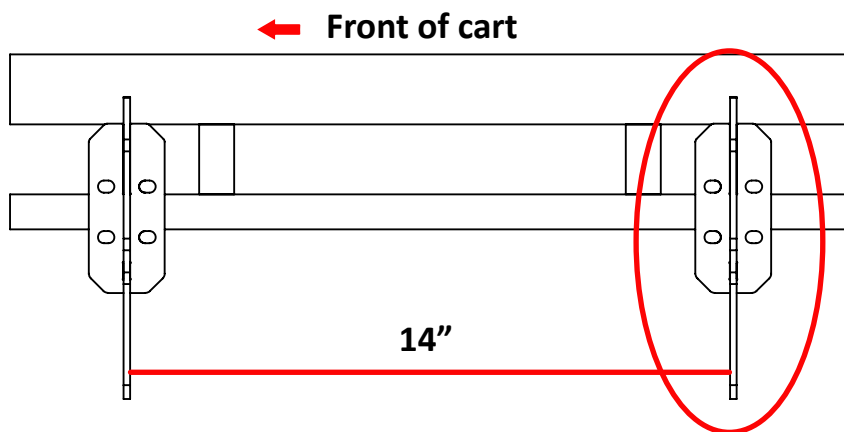

STEP 4:

Secure The Frame brackets with the (2) Fasten plate per bracket. Each bracket gets (2) M8x50mm bolts and flang nuts.

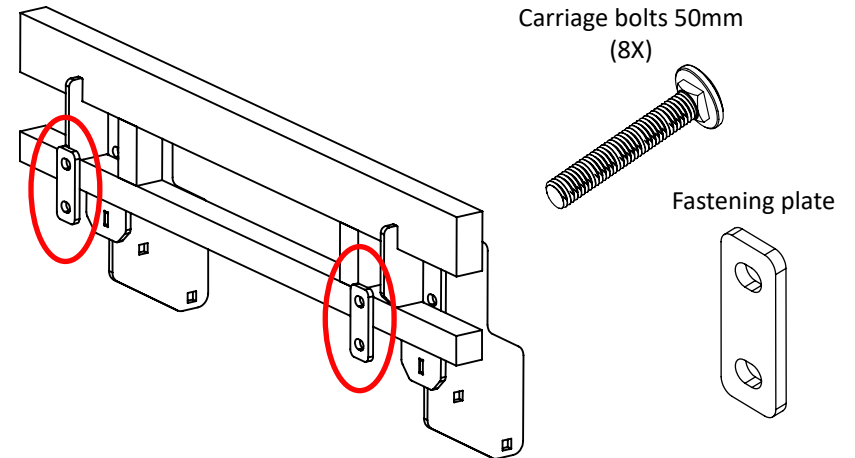

Tip: Keep the frame bracket loose until the last step. You will need to be able to easily slide the bracket forward and back to get the best fitment.

STEP 5:

Place the side sidestep on the ground surface. Position the step assembly between the frame brackets. Adjust brackets if needed.

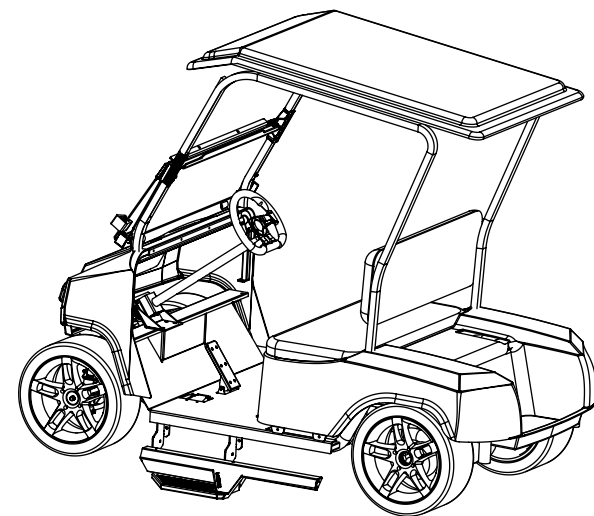

Rotate the side step until one set of bolt holes line up to the frame bracket assembly.

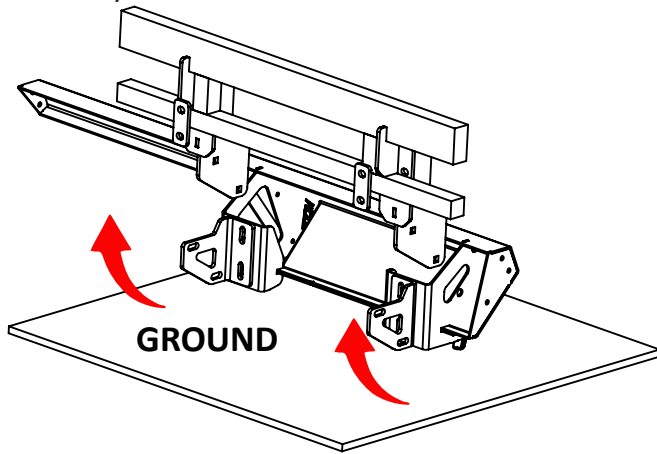

Use (2) M8x20 bolts and Flang nuts to hold into place. keep loose.

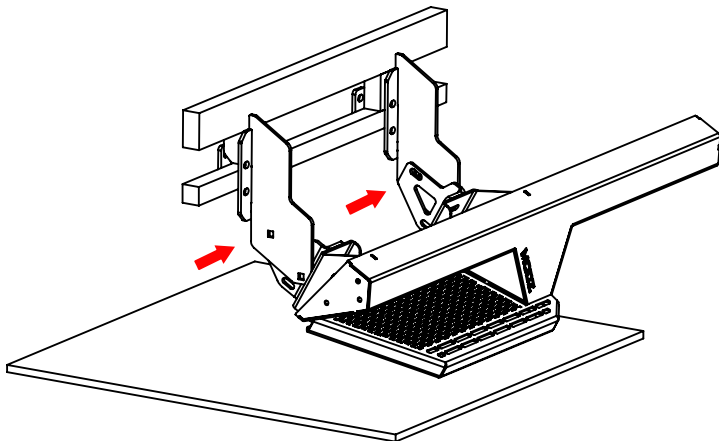

With one set of bolts in place, rotate the rest of the sidestep assembly up until the adjustment bracket lines up with the frame bracket holes and the step is level. Secure with (2) more M8x20 bolts and nuts.

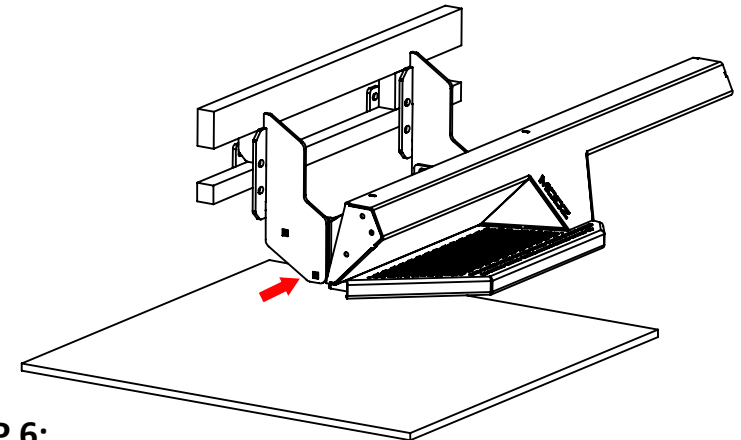
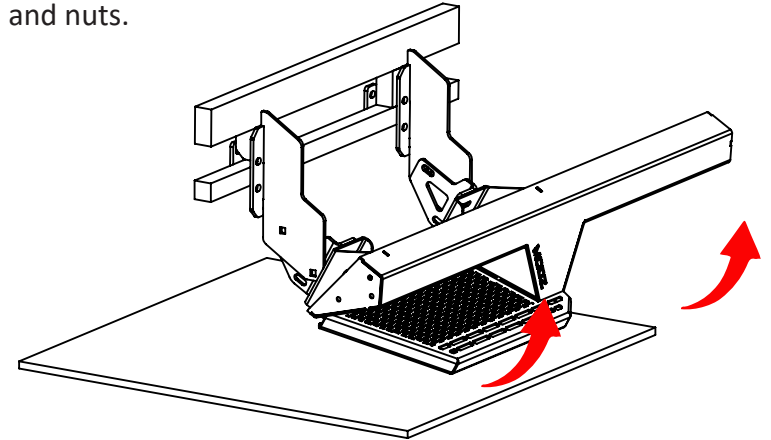

STEP 6:

Now that the sidestep is installed. Now is the time to do final fitment/adjustment. When you are ok with the placement. Tighten down all hardware.

STEP 7:

Repeat steps 1-6 for the passanger side.